

LANDSCAPE MATERIALS SCHEDULE:

SYM.	QTY.	COMMON NAME	BOTANICAL NAME	SIZE	SPACING / REMARKS
CFW	10	Weaver Dogwood	Cornus florida Weaver	30 Gal.	8' oah min, 4' apr. min, 2-1/2' calp.
IVF	6	Will Fleming upright	Ilex vomitoria Will Fleming upright	15 Gal.	8' oah min, 4' apr. min, 2" calp.
IVW	3	Weeping Yaupon	Ilex vomitoria Weeping Yaupon	30 Gal.	1' oah min, 25' apr. min, 2-1/2' calp.
LIN	1	Crape Myrtle - White	Lagerstroemia indica Natchez	F.S.	14' oah min, 6' apr. min, Standard Trunk
LIT	2	Crape Myrtle - Tuscarora	Lagerstroemia indica Tuscarora	F.S.	14' oah min, 6' apr. min, multi-trunk
LT	3	Tulip Poplar	Liriodendron tulipifera	30 Gal.	8' oah min, 4' apr. min, 1-1/2"-2" calp.
QV	3	Live Oak	Quercus virginiana	45 Gal.	12' oah min, 5' apr. min, 3" calp.
UA	3	Winged Elm	Ulmus alata	45 Gal.	10' oah min, 5' apr. min, 3" calp.

SYM.	QTY.	COMMON NAME	BOTANICAL NAME	SIZE	SPACING / REMARKS
AE	24	Cast Iron Plant	Aspidistra elatior	1 Gal.	25' o.c., 14" h. min, 10" apr. min.
CJ	4	Canella	Canella japonica	1 Gal.	5' o.c., 40"-54" h. min, 36" apr. min, pink
HQ	1	Oak Leaf Hydrangea	Hydrangea quercifolia	3 Gal.	3' o.c.
HRS	62	Scrub Wort	Hypericum reductum	1 Gal.	10" o.c.
HX	100	'Double Talk' Daylily	Hemerocallis 'Double Talk'	1 Gal.	2' o.c., 12" h. min, 8" apr. min.
ICR	40	Chinese Holly	Ilex cornuta 'Rotunda'	3 Gal.	3' o.c., 24" h. min, 18" apr. min.
IF	14	Star Anise	Illicium floridanum	3 Gal.	3' o.c., 24" h. min, 18" apr. min.
JP	91	Pearsoni Juniper	Juniperus squamata 'Pearsoni'	3 Gal.	2' o.c., 24" spread min.
PM	5	Yew Podocarpus	Podocarpus macrophyllus	1 Gal.	3' o.c.
RIA	10	Indian Hawthorn	Raphiolepis indica 'Alba'	3 Gal.	25' o.c., 24" height min.
T.A	484	Asiatic Jasmine	Trachelospermum asiaticum	4" pots	12" o.c., full pots
T.A.T.	4710	Variegated Asiatic Jasmine	Trachelospermum asiaticum 'Tricolor'	4" pots	12" o.c.
T.J.	86	Confederate Jasmine	Trachelospermum jasminoides	3 Gal.	16" o.c., 6-10 runners, 24" runners staked
VM	31	Shiny Blueberry	Vaccinium myrsinites	3 Gal.	3' o.c.
VO	28	Walters Viburnum	Viburnum coccineum	3 Gal.	35' o.c., 24" h. min, 24" apr. min.

SYM.	QTY.	COMMON NAME	BOTANICAL NAME	SIZE	SPACING / REMARKS
CR	5	Sago Palm	Cycas revoluta	15 Gal.	32" h. min, 32" apr. min.
CR-2'	2	Sago Palm	Cycas revoluta	F.S.	2' ct. min, 48" apr. min.
CR-3'	2	Sago Palm	Cycas revoluta	F.S.	3' ct. min, 48" apr. min.
CR-5'	2	Sago Palm	Cycas revoluta	F.S.	5' ct. min, 48" apr. min.
P.S.	4	Sellow	Philodendron sellowii	3 Gal.	3' oah
SP-14'	2	Cabbage Palm	Sabal palmetto	F.S.	14' oah, ct. - no boots, hurricane cut and staked
SP-16'	2	Cabbage Palm	Sabal palmetto	F.S.	16' oah, ct. - no boots, hurricane cut and staked
SP-22'	2	Cabbage Palm	Sabal palmetto	F.S.	22' oah, ct. - no boots, hurricane cut and staked
SR	12	Silver Saw Palmetto	Serenoa repens	3 Gal.	2' h, 2' apr. min.
ZF	66	Coontie	Zamia floridana	3 Gal.	2' h, 2' apr. min.

SYM.	QTY.	COMMON NAME	BOTANICAL NAME	SIZE	SPACING / REMARKS
SOD	*	St. Augustine Floraten'	Stenotaphrum secundatum		TSA-free, Sand grow
MULCH	*	Pine Bark 'mini' Nuggets			3" minimum layer

* Landscape Contractor shall verify all plant quantities prior to bid.
* Gravel to be installed by others.

LANDSCAPE PLANTING NOTES:

- CONTRACTOR SHALL VERIFY THE LOCATION OF UTILITIES AND EXISTING TREES AND VEGETATION PRIOR TO THE COMMENCEMENT OF THE LANDSCAPE WORK.
- THE CONTRACTOR SHALL PROTECT ALL TREES DESIGNATED TO BE SAVED FROM DAMAGE DURING CONSTRUCTION USING TREE BARRICADES WITH REASONABLE PROTECTION ZONES AS CONSTRUCTION PERMITS. NO STORAGE OF FUEL OR CONSTRUCTION MATERIALS SHALL BE PERMITTED AROUND TREES TO BE SAVED.
- ALL TREES AND SHRUBS SHALL BE OF THE SIZES AS CALLED FOR IN THE LANDSCAPE MATERIAL SCHEDULE. ANY MATERIALS AS DETERMINED BY THE LANDSCAPE ARCHITECT AS NOT MEETING THE SIZES AND QUALITY AS CALLED FOR SHALL BE REMOVED FROM THE SITE. TREES SHALL BE STAKED AS NEEDED.
- ALL PLANT MATERIAL SHALL BE FLORIDA #1 OR BETTER AS OUTLINED BY GRADES AND STANDARDS FOR NURSERY PLANTS, DIVISION OF PLANT INDUSTRY, FLORIDA DEPARTMENT OF AGRICULTURE AND CONSUMER SERVICES. PLANT MATERIAL SHALL BE CLEARLY IDENTIFIED AS FLORIDA #1 OR BETTER ON EITHER LABELS OR INVOICES.
- MULCH ALL DISTURBED AREA WITH THREE (3) INCH MINIMUM LAYER OF PINE BARK NUGGETS AS INDICATED.
- WATER ALL PLANT MATERIAL IMMEDIATELY AFTER PLANTING. THE LANDSCAPE CONTRACTOR SHALL BE RESPONSIBLE FOR THE WATER AND IRRIGATION FUNCTIONING ADEQUATELY FROM THE TIME OF PLANTING UNTIL ONE YEAR AFTER ACCEPTANCE BY THE OWNER, TO INSURE THAT THE PLANT MATERIAL SURVIVES.
- IF QUANTITIES DIFFER BETWEEN PLAN AND SCHEDULE, THOSE ON THE PLAN SHALL GOVERN. THE CONTRACTOR SHALL VERIFY THAT THE QUANTITIES INDICATED WILL PROVIDE THE COVERAGE AS SPECIFIED AND REPORT ANY DISCREPANCIES TO THE LANDSCAPE ARCHITECT AT THE TIME OF BIDDING.
- ALL PLANT MATERIAL SHALL BE GUARANTEED ONE YEAR AFTER ACCEPTANCE BY THE OWNER.
- ALL SHRUB MATERIAL SHALL BE PLANTED IN STAGGERED ROWS, SPACED ON CENTER (O.C.) AS INDICATED.
- WATERING WILL BE ACCOMPLISHED BY THE USE OF AN UNDERGROUND IRRIGATION SYSTEM, SEE SHEET 102 FOR IRRIGATION PLAN.
- OSMOCOTE "FLORIDA BLEND" SLOW RELEASE FERTILIZER IS TO BE INSTALLED IN EACH PLANTING HOLE PRIOR TO INSTALLATION OF ALL SHRUBS AND GROUND COVERS, FOLLOWING THE MANUFACTURERS SPECIFICATIONS.
- ALL TREES WRAPPED IN BURLAP, PLANTING BAGS, OR ANY OTHER FABRIC WILL HAVE THIS MATERIAL CUT ON FOUR SIDES THE ENTIRE LENGTH OF THE BALL, AND MATERIAL REMOVED FROM THE SITE.
- REMOVAL OF ALL CONSTRUCTION DEBRIS, LIMESTONE, EXCESS OF BUILDERS SAND, CONCRETE AND MORTAR DEBRIS, EXISTING WEEDS AND GRASSES, AND ALL FOREIGN MATERIALS IN THE PLANTING BED AND SOD AREAS SHALL BE REMOVED AND CLEAN BLACK SOIL SHALL BE INSTALLED PRIOR TO ANY INSTALLATION OF PLANTS OR TREES.
- ALL EXISTING AND PROPOSED TREES IN SOD TO BE IN A (6) FOOT MINIMUM MULCHED RING AROUND TRUNK.
- ALL TREES PLANTED IN SOD TO HAVE (12) INCH PLASTIC PROTECTOR (BLACK FLEXIBLE 6" PIPE) AROUND TRUNK BASE TO PROTECT FROM MOWING DAMAGE.
- CONTRACTOR WILL BE RESPONSIBLE TO REPLACE ALL DAMAGED PLANT MATERIAL.
- TREES MUST BE MAINTAINED WITH REGARDS TO WEEDING AND MULCHING FOR ONE YEAR.

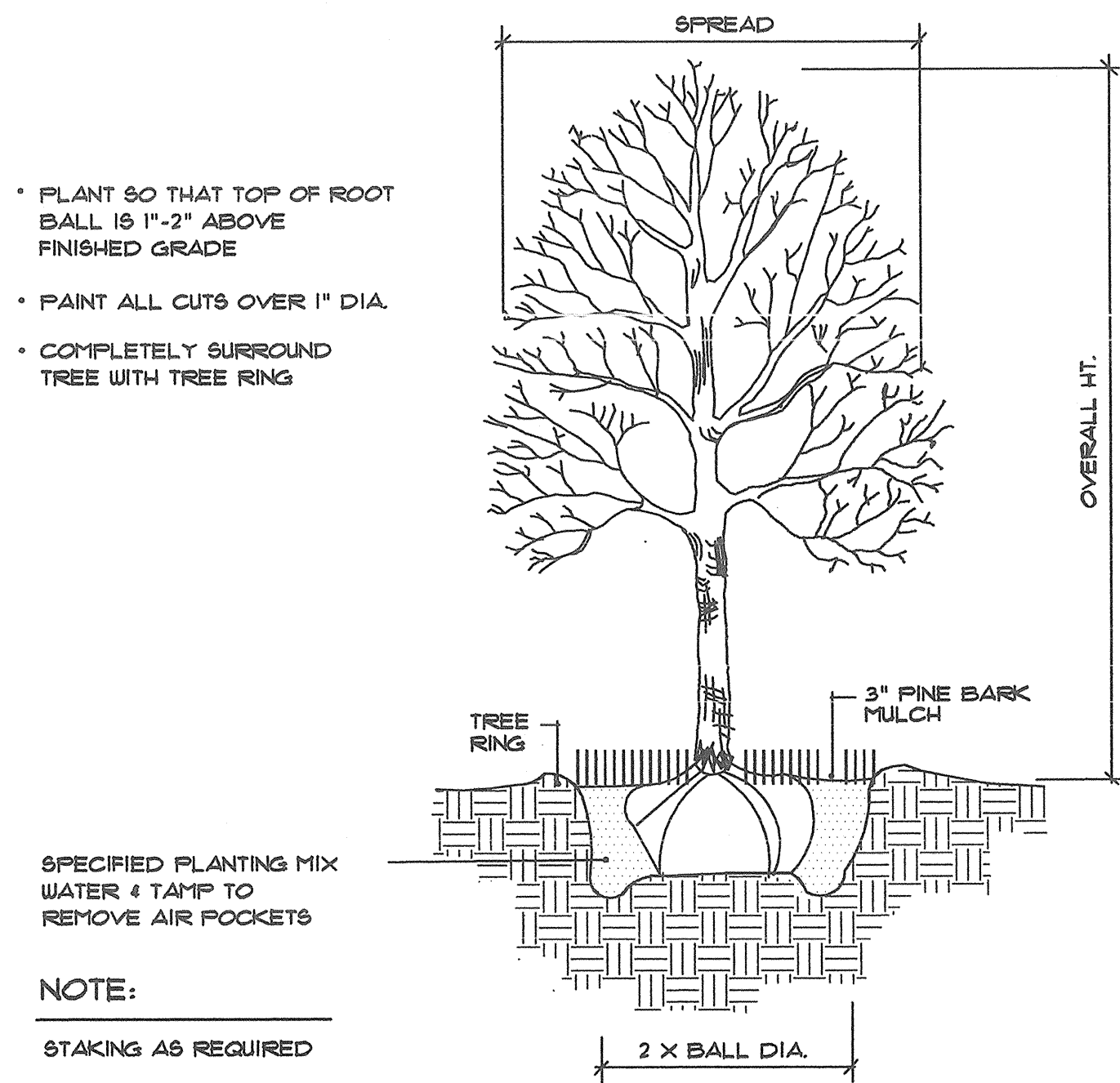

1 TREE PLANTING DETAIL
SCALE: NOT TO SCALE

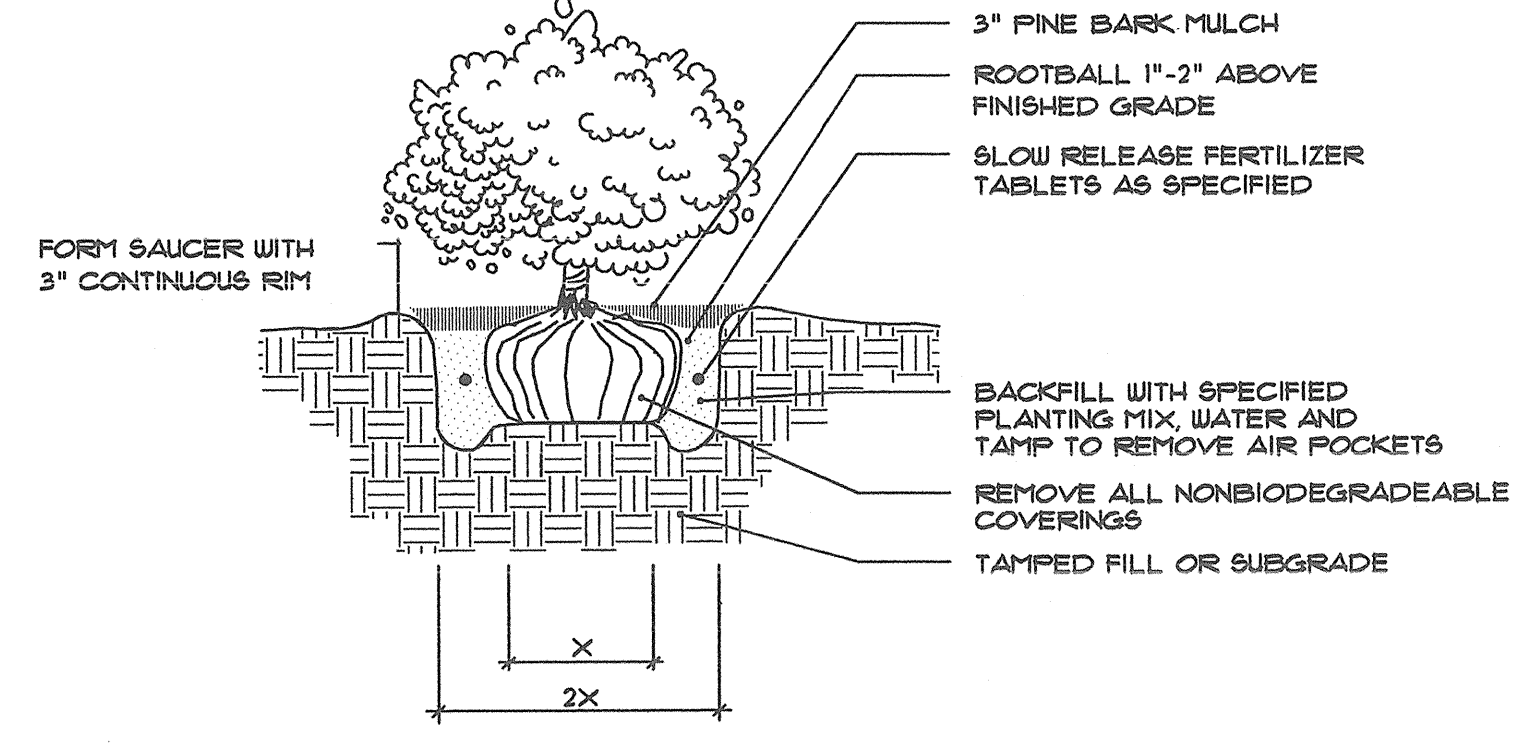

2 SHRUB PLANTING DETAIL
SCALE: NOT TO SCALE

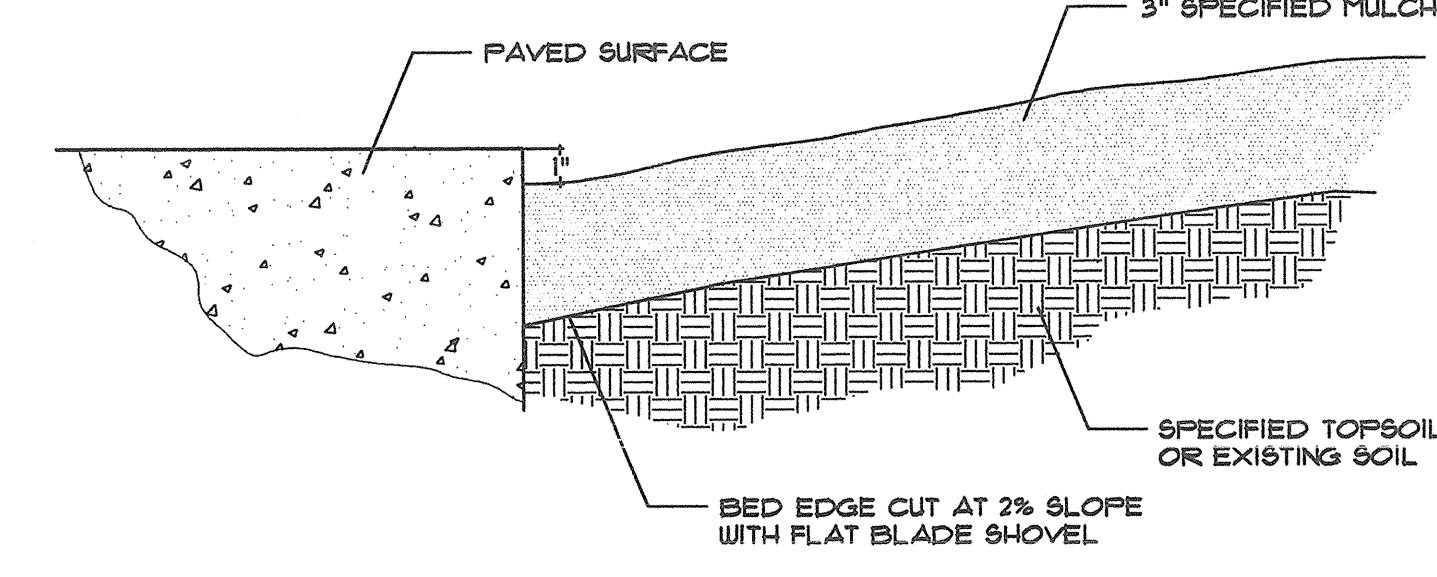

3 MULCHED BED DETAIL
SCALE: NOT TO SCALE

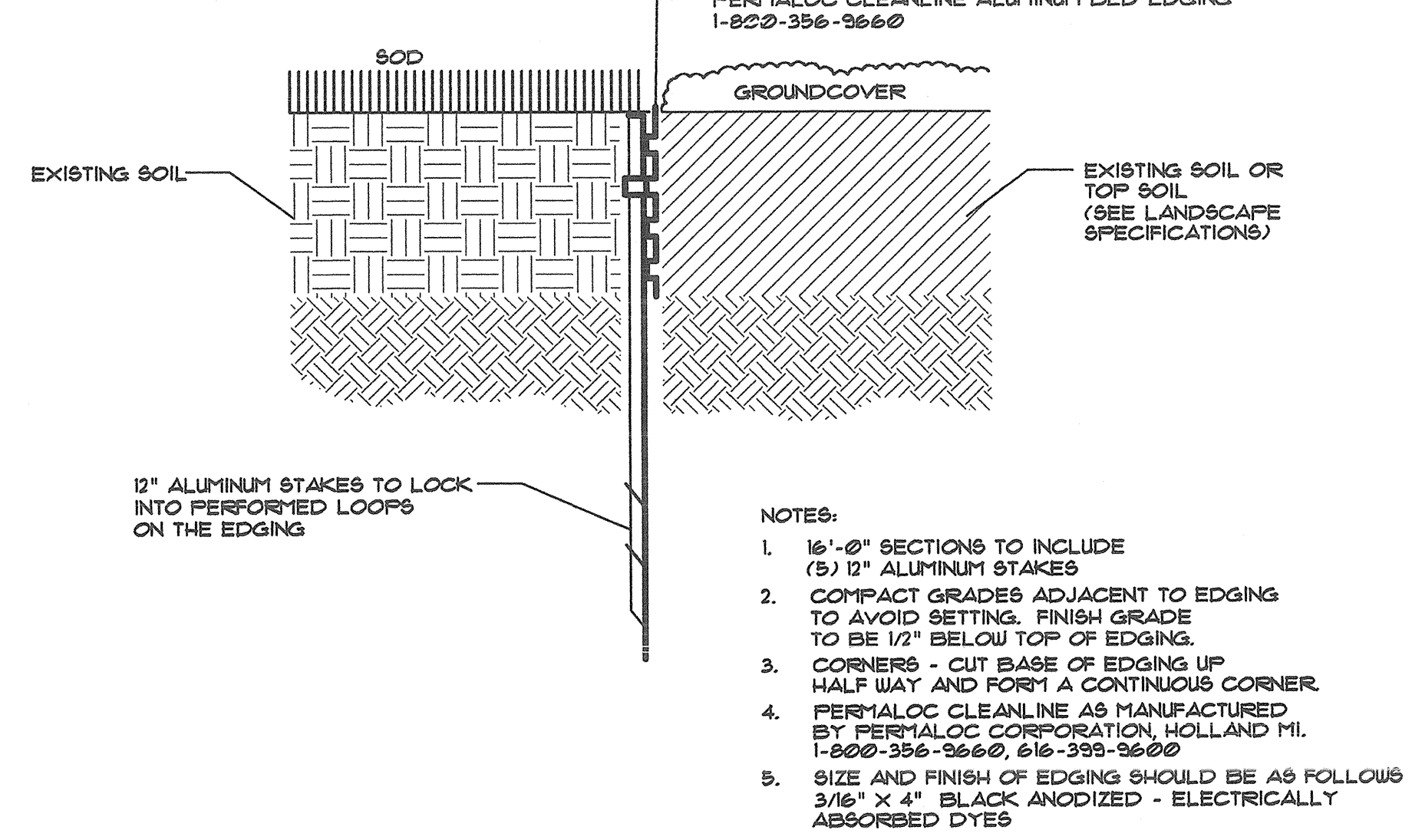

4 BED EDGING DETAIL
SCALE: NOT TO SCALE

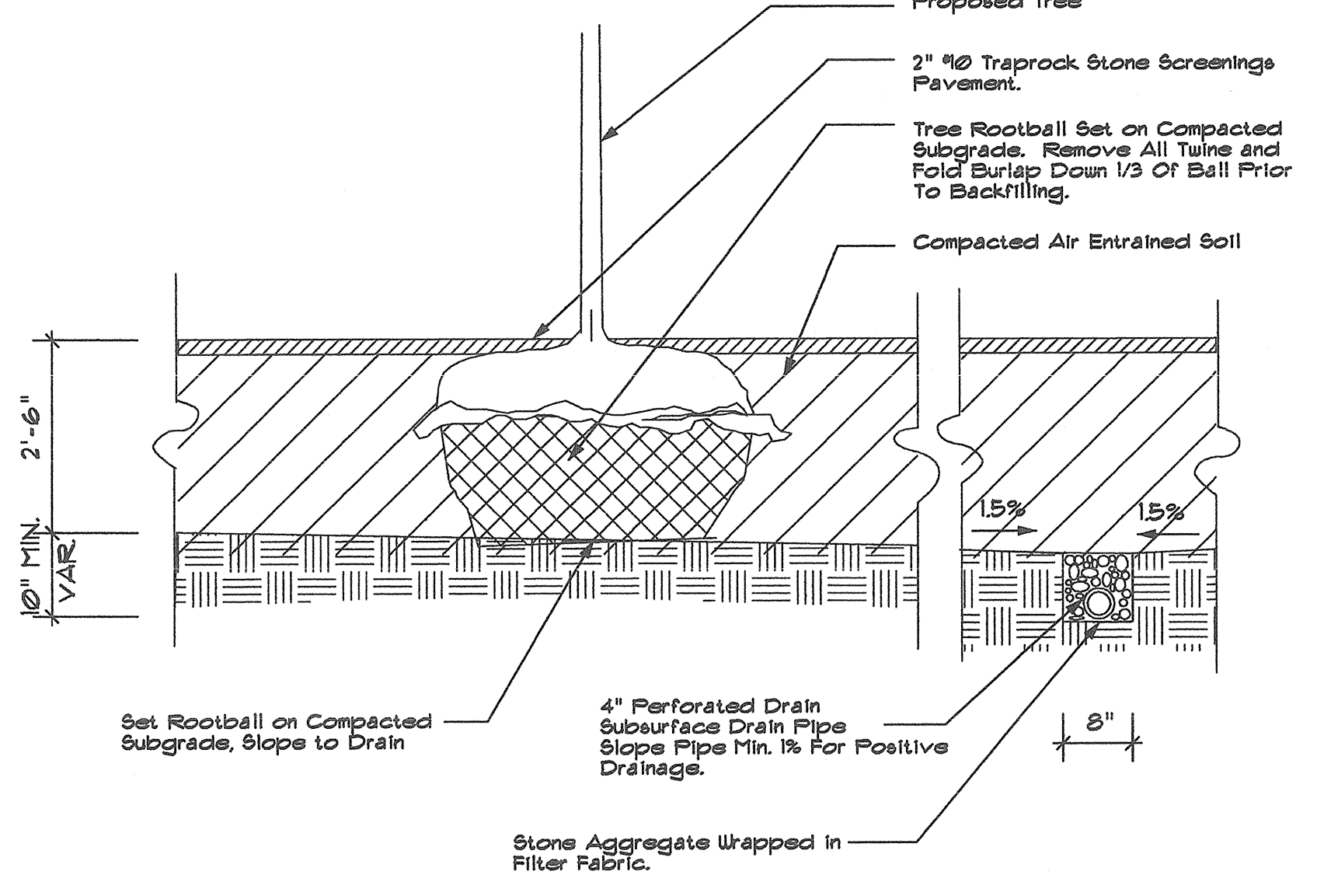

5 TREE IN SCREENINGS PAVEMENT
SCALE: NOT TO SCALE

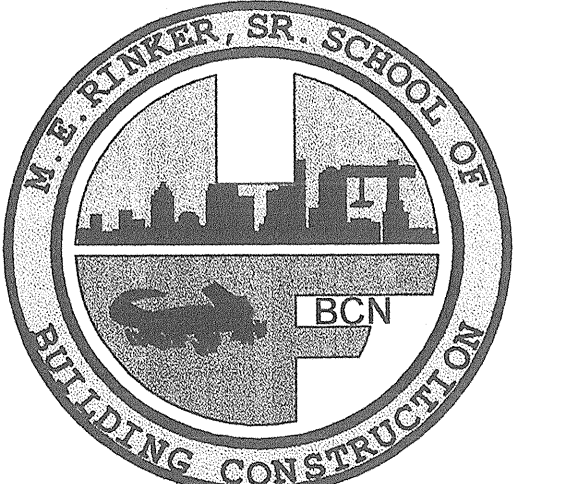

M.E. RINKER, Sr. HALL
SCHOOL OF BUILDING CONSTRUCTION
UNIVERSITY OF FLORIDA-GAINESVILLE
PROJECT NO. BR-191

ARCHITECT
CROXTON COLLABORATIVE/
GOULD EVANS ASSOCIATES

CROXTON COLLABORATIVE ARCHITECTS
475 FIFTH AVENUE
NEW YORK, NY 10017
TEL: 212.683.1988
FAX: 212.683.2798

GOULD EVANS ASSOCIATES
5405 WEST CYPRESS STREET
TAMPA, FL 33607
TEL: 813.288.0729
FAX: 813.288.0231

MECHANICAL ENGINEER
LEHR ASSOCIATES
130 WEST 30TH STREET
NEW YORK, NY 10001-4082
TEL: 212.947.8550
FAX: 212.947.2050

STRUCTURAL ENGINEER
WALTER P. MOORE
201 EAST KENNEDY BOULEVARD
TAMPA, FL 33602
TEL: 813.221.2424
FAX: 813.221.2289

CIVIL ENGINEER
BROWN & CULLEN, INC.
3530 NW 43 STREET
GAINESVILLE, FL 32605
TEL: 352.375.8899
FAX: 352.375.8833

LANDSCAPE ARCHITECT
MCCLEIN DESIGN GROUP, INC.
1943 NW 39 DRIVE
GAINESVILLE, FL 32605
TEL: 352.372.8808
FAX: 352.372.8822

CONSULTANT
SEEGY-BRISCH
AUSSENE STRASSCHER STR. 118
NURNBERG, GERMANY
TEL: 0911/59 90 99
FAX: 0911/59 98 05

THIS DRAWING, AS AN INSTRUMENT OF SERVICE, IS AND SHALL REMAIN THE PROPERTY OF CROXTON COLLABORATIVE ARCHITECTS. THIS DRAWING SHALL NOT BE REPRODUCED, PUBLISHED, USED ON OTHER PROJECTS, USED FOR ADVERTISEMENTS, OR USED IN CONNECTION WITH THIS PROJECT BY OTHERS EXCEPT BY AGREEMENT IN WRITING. © 2001 CROXTON COLLABORATIVE ARCHITECTS/GOULD EVANS ASSOCIATES.

100% CONSTRUCTION DOCUMENTS

LANDSCAPE NOTES

DATE: 11/21/01
SCALE: 20"=1'-0"
DRAWN BY/CHECKED BY: JHB
DRAWING NUMBER: L-102

McCLAIN DESIGN GROUP, INC.
LANDSCAPE ARCHITECTURAL AND GRAPHIC SERVICES
GAINESVILLE, FLORIDA EMAIL: MDTRE@AOL.COM
FAX: (352) 372-8622 PHONE: (352) 372-2808

DMC
4/4/01